

# TONDA ES RANGE

PROTECTED CEILING-MOUNTING LUMINAIRES

**GEWISS**

## TECHNICAL CHARACTERISTICS

### COMPLIANCE WITH STANDARDS

EN 60598-1 - EN60598-2-5

### MATERIALS AND FINISHINGS

Casing:	polycarbonate Grey RAL 7035
Impact resistance:	12 J
Glow wire test:	850°C
Reflector:	polycarbonate (version FSD/FSS)
Impact resistance:	20 J
Glow wire test:	850°C
Anodized aluminium (versions IA - IB)	
Diffuser:	sandblasted and prismatic polycarbonate stabilized to U.V. rays
Impact resistance:	20 J
Glow wire test:	850°C

### WIRING

Supply unit:	internal
Lampholder:	polycarbonate
Two-pole supply terminal:	polyamide for cables of cross-section 2.5 mm <sup>2</sup>
Cables:	rigid, PVC insulated

### ACCESSORIES SUPPLIED

Packaging: heat shrink film

### BEHAVIOUR WITH CHEMICAL AND CORROSIVE AGENTS\*

Water	Sea air	Acids	Bases	Ketones	Spirits	Silicone oil	Oils/Greases	Petrol
Resistant	Resistant	Limited resistance	Limited resistance	Limited resistance	Resistant	Resistant	Limited resistance	Limited resistance

For behaviour with other chemical agents, see the section "General technical information".

# TONDA ES RANGE

PROTECTED CEILING-MOUNTING LUMINAIRES



## TECHNICAL CHARACTERISTICS

### PHOTOMETRIC CURVES

TONDA ES 60W IA

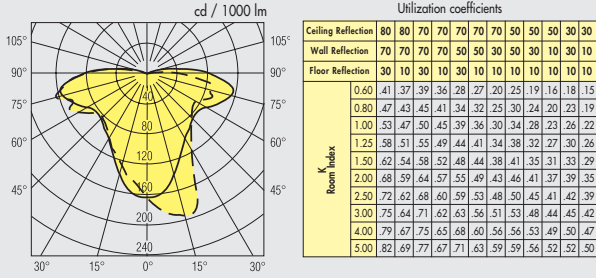

TONDA ES 1X7W FSD

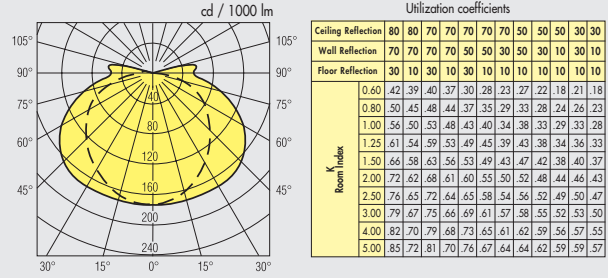

TONDA ES 100W IA

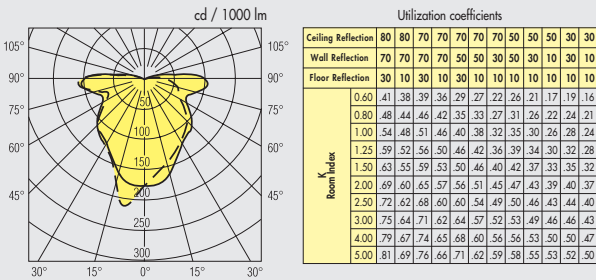

TONDA ES 1X9W FSD

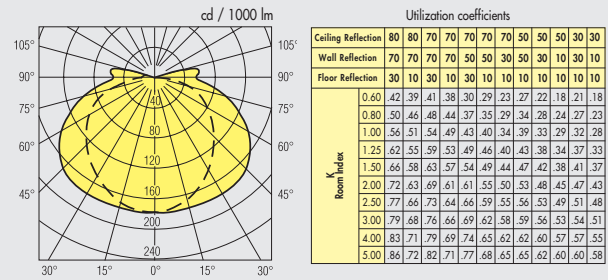

### DIMENSION TABLES

#### TONDA ES

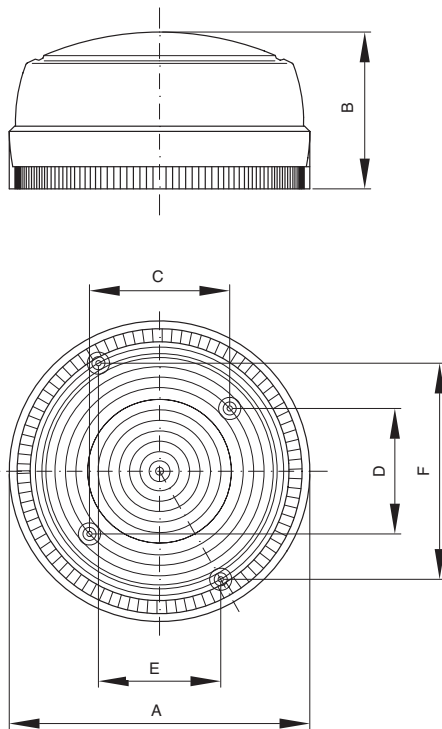

LAMP POWER	A	B	C	D	E	F
60W	180	105	107	96	-	-
100W	230	120	-	-	95	164
1 x 7W	180	105	107	96	-	-
1 x 9W	230	120	-	-	95	164
1 x 16W	230	120	-	-	-	164