

MSS - SWITCH ROTARY DISCONNECTORS UP TO 630A

TECHNICAL DATA

TYPE		MSS 125 THREE-WAY SWITCH I O II			MSS 160	MSS 250	MSS 630		
Reference Standard		EN 60947-3							
Thermal current I _{th} at 40°C (A)		63	100	125	160	250	400	630	
Nominal operating voltage U _e [V]		690 a.c.	690 a.c.	690 a.c.	690 a.c.	690 a.c.	690 a.c.	690 a.c.	
		440 d.c.	440 d.c.	440 d.c.	440 d.c.	220 d.c.	220 d.c.	220 d.c.	
Insulating voltage U _i [V]		800 a.c.	800 a.c.	800 a.c.	800 a.c.	800 a.c.	1000 a.c.	1000 a.c.	
Nominal impulse voltage U _{imp} (kV)		8	8	8	8	8	12	12	
Category of usage (current in A)									
400V a.c.	AC-22A / AC-22B	63	100	125	160	250	400	630	
	AC-23A/AC-23B	63	63	63	160	250	400	500	
220V d.c.	DC-22A / DC-22B	63(*)	100(*)	100(*)	160(*)	250(*)	400(*)	500(*)	
	DC-23A/DC-23B	63(*)	63(*)	63(*)	160(*)	200(*)	400(*)	500(*)	
Short duration current allowed for 1s I _{cw} (kA)		2.5	2.5	2.5	4	9	13	13	
Closing capacity I _{cm} (kA) (peak value)		12	12	12	16	23	45	45	
Short-circuit conditioned current with fuse gG (kA)		100	100	100	50	100	100	100	
Maximum current fuse gG (kA)		63	100	125	160	250	400	630	
Dissipated power per pole (W)		1.2	3.1	5.7	3.3	5.8	10.8	30.9	
Mechanical life (no. of operation cycles)		20.000	20.000	20.000	10.000	10.000	5.000	5.000	
Max. conductor section (mm ²)		50	50	50					
Max. bar width (mm)					20	32	40	50	
Co-ordination between MSS automatic breakers and isolators									
Max. I _{cc} endured by MSS [kA]MT 60		6	6	6					
	MT 100	10	10	10					
	MTHP 160	16	16	16	16				
	MTHP 250	25	25	25					
	MTS 160	B	12	11	11	16	16		
		N	12	11	11	20	36		
	MTS 250	N	10	10	10	16	36		
		H	10	10	10	16	36		
		L	10	10	10	16	36		
	MTSE 250	N	8	8	8	10	28		
		H	8	8	8	10	28		
		L	8	8	8	10	28		
	MTS 630	N					22	36	
		MTSE 630	H					22	55
			L					22	55
	MTS 800	N						36	
		MTSE 800	S						40
			H						40
			L						40

(*) 2 poles in series according to polarity.

97 MSS RANGE

DIMENSION TABLES

MSS 125

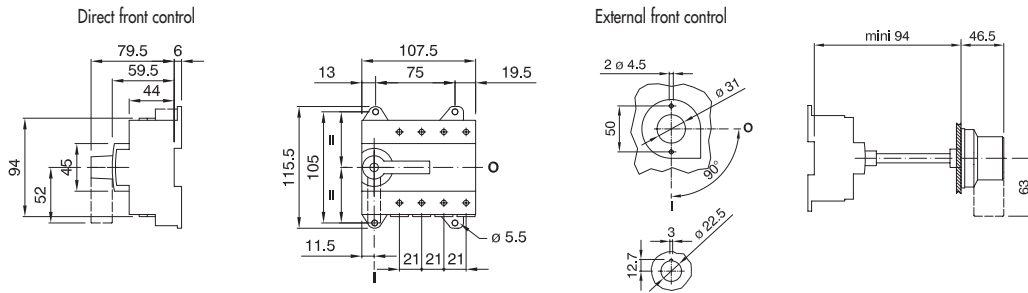

MSS 160

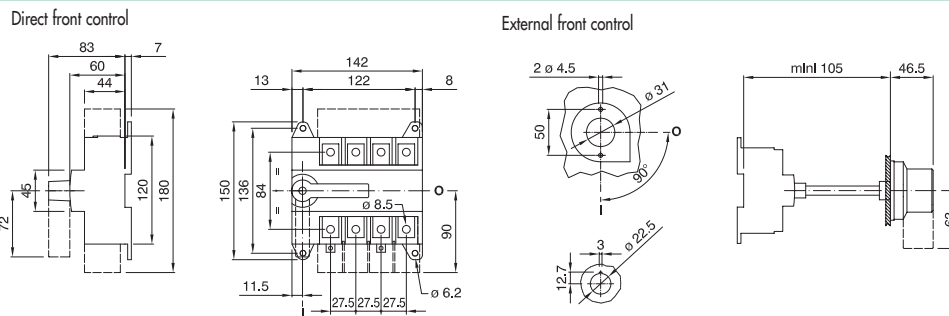

MSS 250-630

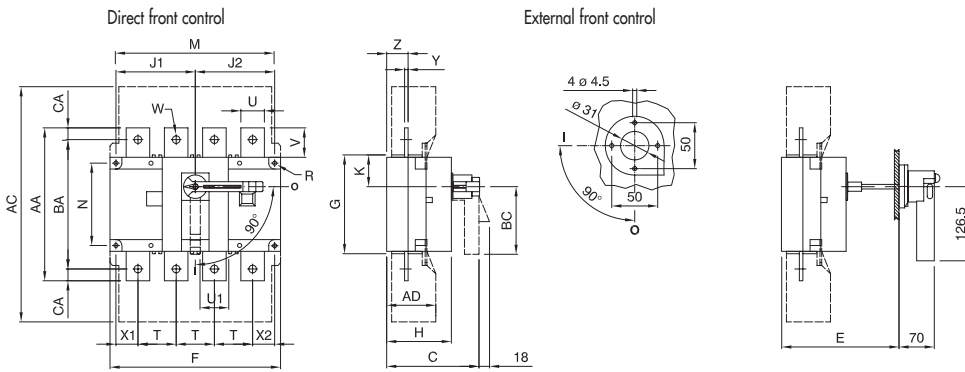

Gauge	External	Terminal covers	Box										Fixing						Connection													
(A)	C	E	AC	AD	3	4	G	H	J1	3p.	J1	4p.	J2	K	BC	M 3p.	M 4p.	N	R	T	U	U1	V	W	X1 3p.	X1 4p.	X2	Y	Z	AA	BA	CA
250	130	148.166	290	60	180	230	108	75	55	105	105	34	115	160	210	80	5.5	50	25	25.5	30	11	33	33	27	3.5	22.5	160	130	15		
400	165	182.200	401	89	230	290	170	110	75	135	135	55	115	210	270	140	7	65	32	45.5	37.5	11	42.5	37.5	37.5	5	36	235	305	15		
630	165	182.200	401	89	230	290	170	110	75	135	135	55	115	210	270	140	7	65	45	45.5	37.5	13	42.5	37.5	37.5	5	36	260	220	20		

SWITCH I O II

